

OREGON LAKES AND RESERVOIRS

UNION COUNTY

**MASTER PLAN
FOR ANGLER ACCESS AND
ASSOCIATED RECREATIONAL
USES**



**Oregon State Game Commission
Lands Division**



UNION COUNTY LAKES AND RESERVOIRS
Master Plan for Angler Access
and
Associated Recreational Uses

By

Oregon State Game Commission

Land Section

August 1969

T A B L E O F C O N T E N T S

THE PLAN	1
VICINITY MAP	5
SITE EVALUATIONS	6
APPENDIX - County maps		

UNION COUNTY LAKES AND RESERVOIRS

Master Plan for Angler Access

and

Associated Recreational Uses

This report details a plan that we hope can be followed to solve the access problems of the Union County Lakes and Reservoirs. Too, we hope that all agencies that are interested in retaining existing water access as well as providing additional facilities, whether they be municipal, county, or state, will all join in a cooperative effort to carry out this plan in an orderly manner. It is probable that Land and Water Conservation Funds will be available on a 50-50 matching basis. In order to acquire these funds, it will be necessary to apply through the Oregon State Highway Department.

Union County located in northeastern Oregon encompasses an area of approximately 2,000 square miles. The terrain varies considerably from the flat Grande Ronde Valley in the north to the high rugged peaks of the Eagle Cap Wilderness Area in the southeastern corner of the county.

Angling waters within the county consist of: streams in the foothills and valleys, natural lakes in the mountainous areas and impoundments and small ponds in the valley areas constructed or maintained primarily for fisheries management.

The natural lakes, with the exception of Grande Ronde Lake, are within the Eagle Cap Wilderness Area and are reached by a well developed trail system. Recreational development at these lakes is minimal to preserve the natural wilderness conditions of the area.

Public access to the small ponds in the valley is adequate as access agreements have usually been obtained prior to the initiation of the development and management plans. The development and maintenance of adequate sanitary facilities is needed at most of these sites.

One existing and several potential reservoirs planned for irrigation and flood control have been covered in this report. In order to provide and maintain a fishery in these reservoirs, a minimum pool will have to be secured as well as providing boat and bank access. Where drawdown will be significant, the development of low-water boat access will also be necessary.

The fishery in the lakes and reservoirs of the county consists of rainbow and brook trout. Brown bullheads are also available in one of the smaller ponds. Angling in the early spring is quite intense on the small ponds and larger reservoirs in the lower valleys as the high lakes are usually still snow-bound and the streams are muddy from the spring runoff. During the late spring and summer the pressure shifts to the higher mountain lakes and headwaters of the streams.

We realize in writing a plan of this type that we have not covered all of the potential impoundment sites available. What we have attempted to include are those existing and potential bodies of water that provide or could be developed to provide significant recreation at economically feasible costs. New sites or modifications of existing sites that fit this criteria may be added to this report by supplement in the future.

In this report 14 sites have been considered and evaluated. Recommendations of development to meet the present and future needs of the public are presented on the following evaluation sheets.

VICINITY MAP

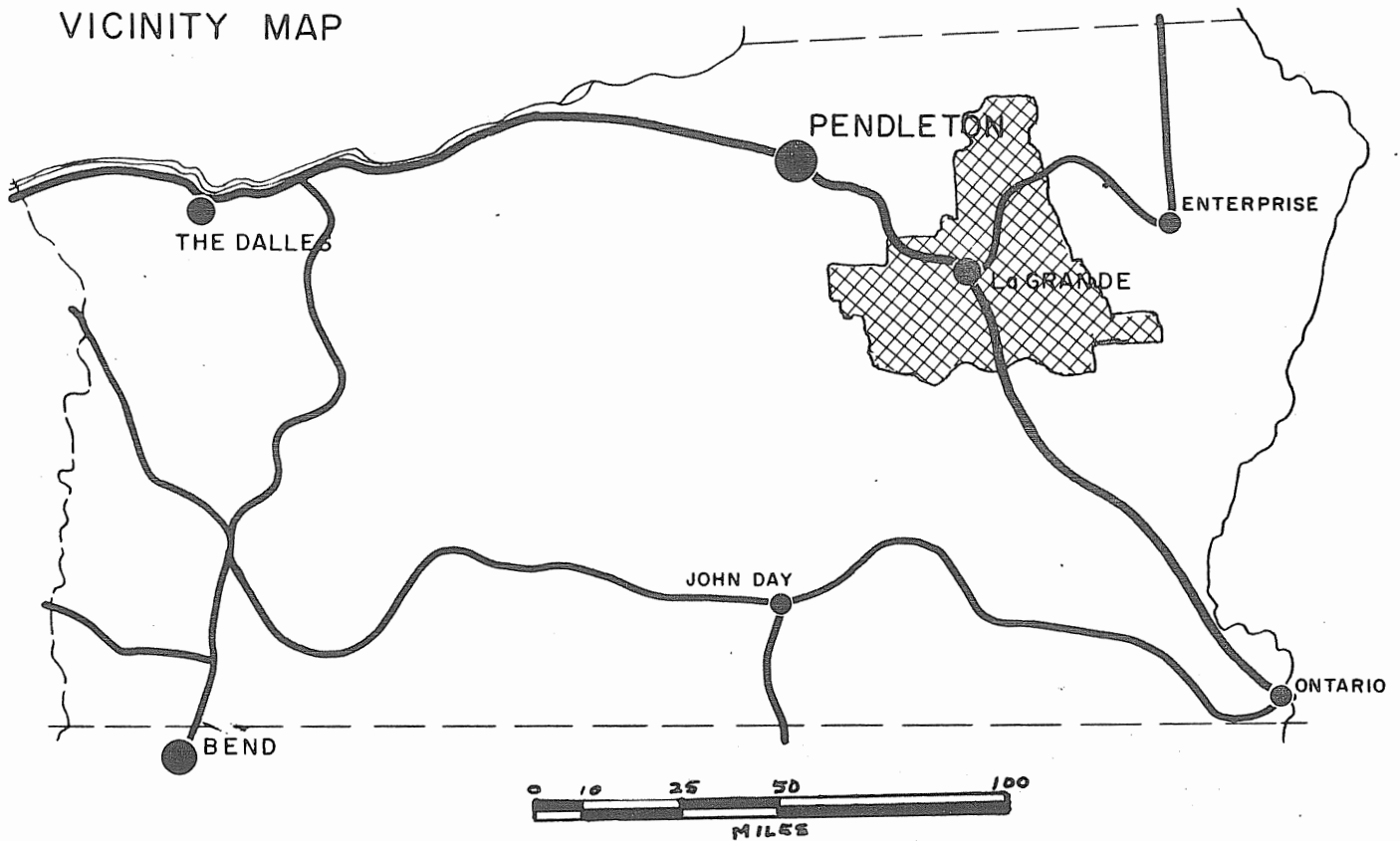

Union County located in northeastern Oregon is connected with the centers of population in western Oregon by Interstate 80N, State Route 204 and State Route 244. The county lies approximately 250 miles east of Portland.

LAKE AND RESERVOIR ACCESS EVALUATION

Priority * A

Name Catherine Creek Reservoir

County Union

Location 10 miles southeast of Union

Township 5 S Range 41 E Sec. 8 Tax Lot No. Many

Ownership Public and private Number of owners Many

DESCRIPTION

Terrain Moderate to steep canyon and meadows along creek.

Cover type Pine, fir, deciduous brush and grass

Existing access Paved state highway
Approx.

Surface acres 1,000 Water quality Good Levels Fluctuating

Present stage of development Proposed project by Army Corps of Engineers

ANGLER NEEDS

Acquisition: 25 acres and a minimum pool.

Type of conveyance Use agreement

Development:

Boat ramp: Type Concrete Number of lanes 2 +

Toilets X Trails X Roads X

Parking area X; for 300 cars and 150 car-trailer units

* This priority refers to the recreational development of the reservoir, not reservoir construction.

POTENTIAL FISHERY: Rainbow Trout

	Spring	Summer	Fall	Winter
Heavy				
Medium				
Light				

(Sa - Salmon, Tr - Trout,
Ww - Warm Water Fishes)

SKETCH

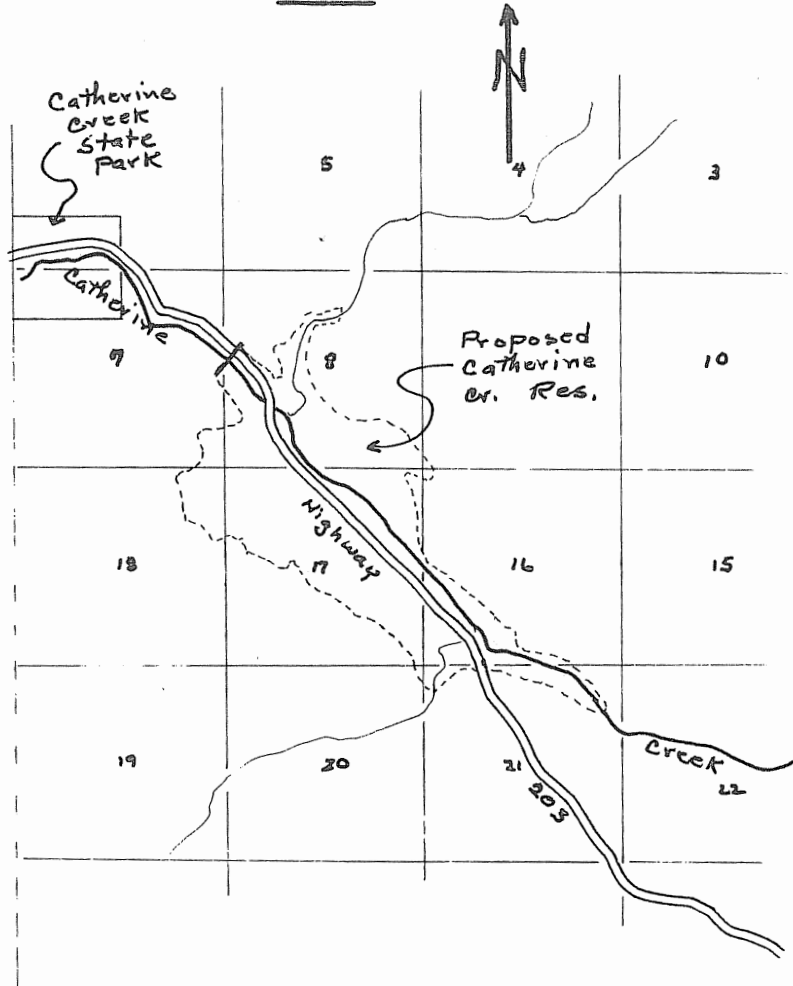

Seasons (Check)

POTENTIAL RECREATION
(Check)

- Boating, motor
- Boating, non-motor
- Camping, tent
- Camping, trailer
- Fishing, boat
- Fishing, shore
- Hiking
- Horseback riding
- Hunting, big game
- Hunting, upland game
- Hunting, waterfowl
- Nature study
- Picnicking
- Sightseeing
- Skin and scuba diving
- Swimming
- Water skiing

	Spring	Summer	Fall	Winter
X	X	X		
X	X	X		
X	X	X		
X	X	X		
X	X	X		
			X	
			X	
X	X	X		
		X	X	
X	X	X		

OTHER

Safety Problems:

Group Facilities should include bus parking, camping and picnicking.

REMARKS

Development plans should include a minimum pool, boat facilities and campgrounds.

LAKE AND RESERVOIR ACCESS EVALUATION

Priority Complete

Name Eagle Cap Wilderness Group County Union

Location Southeast corner of Union County

Township 5 S Range 43,44E Sec. Many Ownership USFS

DESCRIPTION

Terrain Steep, rugged, mountainous

Cover type Conifers to alpine meadows

Elevation 7-9,000 Surface acres 2 - 34 Water quality Good

Existing access Well developed trail system

ANGLER NEEDS

Trail maintenance and signs.

FISHERY

Brook trout, rainbow trout and lake trout.

	Spring	Summer	Fall	Winter
Heavy				
Medium		BTRb,LT		
Light			BTRb,LT	

(Ct - Cutthroat trout, GT - Golden trout, LT - Lake trout, BT - Brook trout, Rb - Rainbow trout, Br - Brown trout, K - Kokanee, Ww - Warm water game fish)

Recreation

	S	S	F	W
Camping		x	x	
Fishing, boat				
Fishing, shore		x	x	
Hiking		x	x	
Horseback riding		x	x	
Hunting, big game				
Hunting, upland game				
Nature study				
Picnicking		x	x	
Sight-seeing				
Swimming				
Water skiing				

REMARKS:

The better angling lakes include: Bear, Eagle, Hidden, Looking-glass, Prospect and Traverse.

LAKE AND RESERVOIR ACCESS EVALUATION

Priority Complete

Name Grande Ronde Lake

County Union

Location Southwest corner of Union County

Township 7 S Range 36 E Sec. 1 Ownership USFS

DESCRIPTION

Terrain Mountainous

Cover type Conifers

Elevation 7,000 Surface acres 11 Water quality Good

Existing access Forest Service road and trail

ANGLER NEEDS

Adequate at this time.

FISHERY

Brook trout.

		<u>Spring</u>	<u>Summer</u>	<u>Fall</u>	<u>Winter</u>	<u>Recreation</u>				
						S	S	F	W	
Heavy										
Medium										
Light			BT	BT						
(Ct - Cutthroat trout, GT - Golden trout, LT - Lake trout, BT - Brook trout, Rb - Rainbow trout, Br - Brown trout, K - Kokanee, Ww - Warm water game fish)										
						Camping				
						Fishing, boat				
						Fishing, shore		X	X	
						Hiking		X	X	
						Horseback riding		X	X	
						Hunting, big game			X	
						Hunting, upland game				
						Nature study				
						Picnicking		X	X	
Sight-seeing										
Swimming										
Water skiing										

REMARKS:

LAKE AND RESERVOIR ACCESS EVALUATION

Priority B

Name Jimmy Creek Reservoir

County Union

Location 5 miles north of North Powder

Township 5 S Range 39 E Sec. 35 Ownership Private

DESCRIPTION

Terrain Flat valley land with moderate slopes

Cover type Sagebrush and grass

Elevation _____ Surface acres 160 Water quality Good

Existing access Gravel county road

ANGLER NEEDS

Minimum pool for fish management, campgrounds and boat facilities.

POTENTIAL FISHERY

Rainbow trout.

	Spring	Summer	Fall	Winter	Potential Recreation	S	S	F	W
Heavy					Camping	x	x	x	
Medium					Fishing, boat	x	x	x	
Light					Fishing, shore	x	x	x	
					Hiking				
					Horseback riding				
					Hunting, big game				
					Hunting, upland game				
					Nature study				
					Picnicking	x	x	x	
					Sight-seeing				
					Swimming		x		
					Water skiing	x	x	x	

(Ct - Cutthroat trout, GT - Golden trout, LT - Lake trout, BT - Brook trout, Rb - Rainbow trout, Br - Brown trout, K - Kokanee, Ww - Warm water game fish)

REMARKS:

This is a potential reservoir proposed by the U.S. Soil Conservation Service.

LAKE AND RESERVOIR ACCESS EVALUATION

Name Jubilee Meadows Priority A
County Union

Location 8 miles northeast of Tollgate
Township 4 N Range 39 E Sec. 8 & 17 Tax Lot No. 100
Ownership U.S. Forest Service Number of owners 1

DESCRIPTION

Terrain Moderate to steep with flat areas along reservoir.
Cover type Pine, fir and deciduous brush.
Existing access Gravel Forest Service road
Surface acres 100 Water quality Good Levels Stable
Present stage of development Completed reservoir with/ campgrounds under construction

ANGLER NEEDS

Acquisition: _____ acres, _____ of frontage
Type of conveyance _____

Development:

Boat ramp: Type Concrete Number of lanes 2
Toilets X Trails X Roads X
Parking area X; for _____ cars or _____ car-trailer units

This site is the result of a cooperative venture between the
U.S. Forest Service and the Oregon State Game Commission.

Name Jubilee Meadows

FISHERY: Planted rainbow trout.

	Spring	Summer	Fall	Winter
Heavy	Tr	Tr		
Medium			Tr	
Light				

(Sa - Salmon, Tr - Trout, Ww - Warm Water Fishes)

SKETCH

Seasons (Check)

	Spring	Summer	Fall	Winter
Boating, motor	X	X	X	
Boating, non-motor	X	X	X	
Camping, tent	X	X	X	
Camping, trailer	X	X	X	
Fishing, boat	X	X	X	
Fishing, shore	X	X	X	
Hiking				
Horseback riding				
Hunting, big game				
Hunting, upland game				
Hunting, waterfowl				
Nature study				
Picnicking	X	X	X	
Sightseeing				
Skin and scuba diving				
Swimming	X	X	X	
Water skiing	X	X	X	

RECREATION
(Check)

- Boating, motor
- Boating, non-motor
- Camping, tent
- Camping, trailer
- Fishing, boat
- Fishing, shore
- Hiking
- Horseback riding
- Hunting, big game
- Hunting, upland game
- Hunting, waterfowl
- Nature study
- Picnicking
- Sightseeing
- Skin and scuba diving
- Swimming
- Water skiing

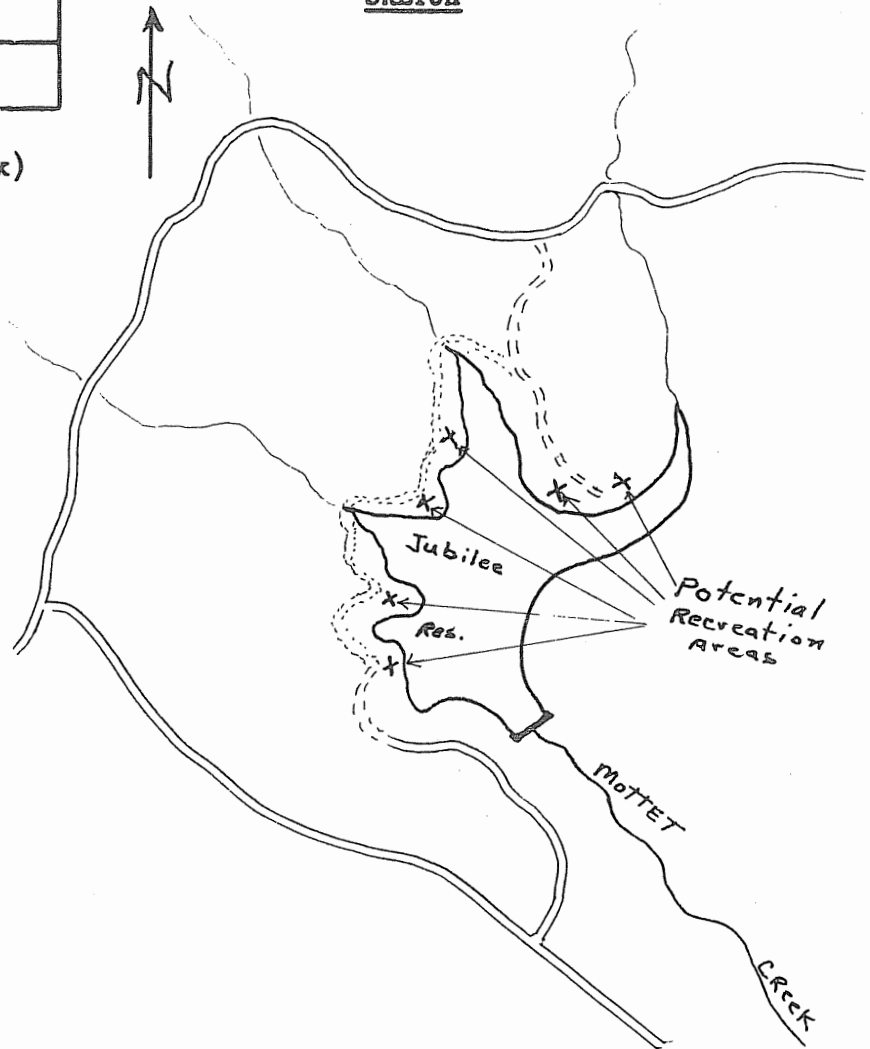

OTHER

Safety Problems:

Group Facilities: Bus parking, camping and picnic facilities.

REMARKS

The campgrounds are being developed and maintained by the U.S. Forest Service.

LAKE AND RESERVOIR ACCESS EVALUATION

Name Lower Grande Ronde Reservoir Priority * A
County Union

Location 11 miles west of LaGrande
Township 3 S Range 36 E Sec. Many Tax Lot No. Many
Ownership Public and private Number of owners Many

DESCRIPTION

Terrain Steep canyon and flat meadows
Cover type Pine, fir, deciduous brush and grass
Existing access Paved state highway
Surface acres 3,000 Water quality Good Levels Fluctuating
Present stage of development Proposed project by Army Corps of Engineers

ANGLER NEEDS

Acquisition: 50 acres and a minimum pool.
Type of conveyance Use agreement

Development:

Boat ramp: Type Concrete Number of lanes 2 +
Toilets X Trails X Roads X
Parking area X; for 500 cars and 250 car-trailer units

This priority refers to the recreational development of the reservoir, not reservoir construction.

Lower Grande
Name Ronde Reservoir

POTENTIAL FISHERY: Rainbow trout

	Spring	Summer	Fall	Winter
Heavy				
Medium				
Light				

(Sa - Salmon, Tr - Trout,
Ww - Warm Water Fishes)

SKETCH

Seasons (Check)

POTENTIAL RECREATION
(Check)

- Boating, motor
- Boating, non-motor
- Camping, tent
- Camping, trailer
- Fishing, boat
- Fishing, shore
- Hiking
- Horseback riding
- Hunting, big game
- Hunting, upland game
- Hunting, waterfowl
- Nature study
- Picnicking
- Sightseeing
- Skin and scuba diving
- Swimming
- Water skiing

	Spring	Summer	Fall	Winter
Boating, motor	X	X	X	
Boating, non-motor	X	X	X	
Camping, tent	X	X	X	
Camping, trailer	X	X	X	
Fishing, boat	X	X	X	
Fishing, shore	X	X	X	
Hiking				
Horseback riding				
Hunting, big game			X	
Hunting, upland game			X	
Hunting, waterfowl				
Nature study				
Picnicking	X	X	X	
Sightseeing				
Skin and scuba diving				
Swimming		X	X	
Water skiing	X	X	X	

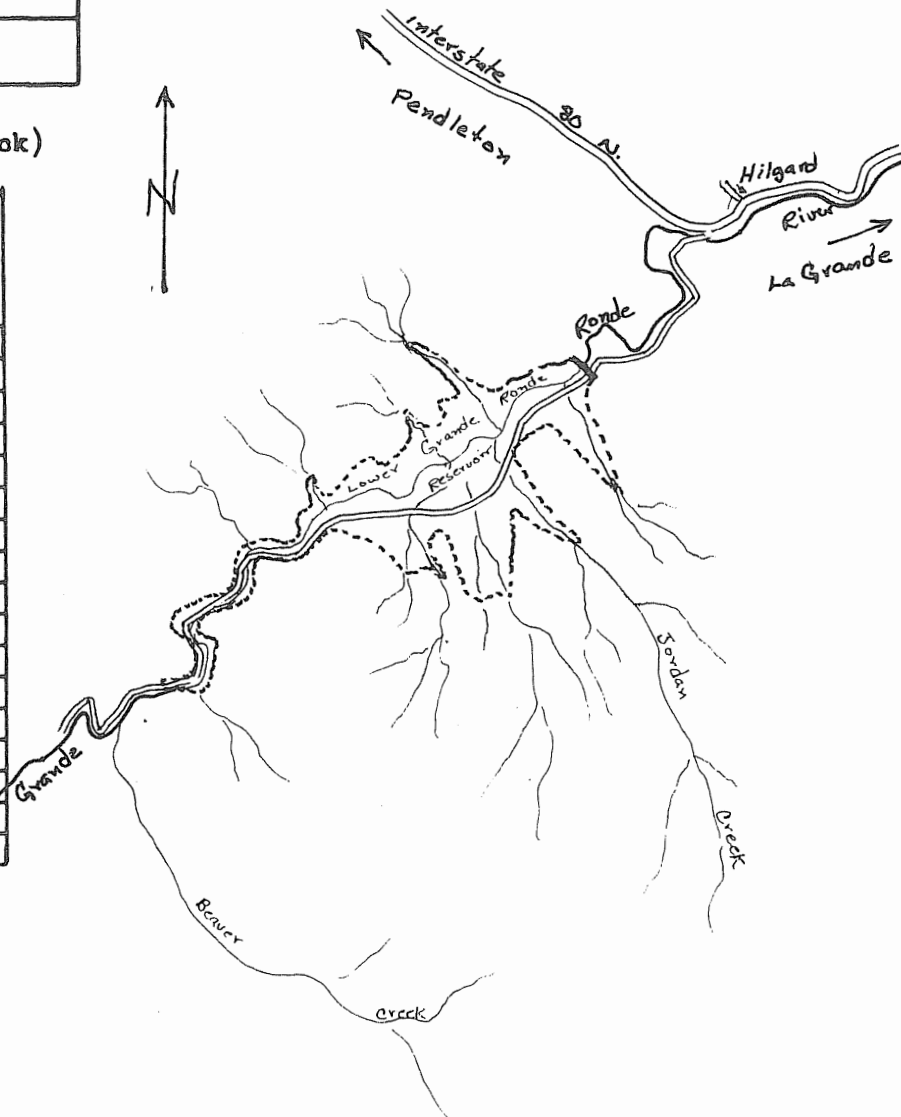

OTHER

Safety Problems:

Group Facilities should include bus parking, camping and picnicking.

REMARKS

Development plans should include a minimum pool, boat facilities and campgrounds.

LAKE AND RESERVOIR ACCESS EVALUATION

Priority B

Name Morgan Lake

County Union

Location 4 miles southwest of LaGrande

Township 3 S Range 37 E Sec. 13 & 14 Ownership City of LaGrande

DESCRIPTION

Terrain Large flat meadow

Cover type Pine, fir, and deciduous brush

Elevation 4,200 Surface acres 65 Water quality Good

Existing access County and private road (permanent easement)

ANGLER NEEDS

Adequate when construction completed as planned.

FISHERY

Planted rainbow trout and brook trout.

	Spring	Summer	Fall	Winter	<u>Recreation</u>			
	Rb, Bt		Rb, Bt		S	S	F	W
Heavy					X	X	X	
Medium					X	X	X	
Light		Rb, Bt			X	X	X	
					X	X	X	

(Ct - Cutthroat trout, GT - Golden trout, LT - Lake trout, BT - Brook trout, Rb - Rainbow trout, Br - Brown trout, K - Kokanee, Ww - Warm water game fish)

REMARKS:
No motors allowed on lake.

LAKE AND RESERVOIR ACCESS EVALUATION

Priority C

Name Park Reservoir

County Union

Location 2 miles north of Medical Springs

Township 6 S Range 41 E Sec. 14 Ownership Private

DESCRIPTION

Terrain Narrow canyon with large meadow

Cover type Pine, fir, willow, deciduous brush and grass

Elevation 3,500 Surface acres 415 Water quality Good

Existing access Paved state highway

ANGLER NEEDS

Minimum pool for fishery management, campgrounds and boat facilities.

POTENTIAL FISHERY

Rainbow trout.

		Spring	Summer	Fall	Winter	<u>Potential Recreation</u>				
Heavy Medium Light						S	S	F	W	
						Camping	X	X	X	
						Fishing, boat	X	X	X	
					Fishing, shore	X	X	X		
					Hiking					
					Horseback riding					
					Hunting, big game					
					Hunting, upland game					
					Nature study					
					Picnicking	X	X	X		
					Sight-seeing					
					Swimming		X			
					Water skiing	X	X	X		

(Ct - Cutthroat trout, GT - Golden trout, LT - Lake trout, BT - Brook trout, Rb - Rainbow trout, Br - Brown trout, K - Kokanee, Ww - Warm water game fish)

REMARKS:

This is a potential reservoir proposed by the U. S. Soil Conservation Service.

LAKE AND RESERVOIR ACCESS EVALUATION

Priority C

Name Pilcher Creek Reservoir

County Union

Location 8 miles west of North Powder

Township 6 S Range 38 E Sec. 22 Ownership Private

DESCRIPTION

Terrain Flat valley with moderate slopes

Cover type Willows, sagebrush and grass

Elevation Surface acres 160 Water quality Good

Existing access Gravel county road

ANGLER NEEDS

Minimum pool for fish management, campgrounds and boat facilities.

POTENTIAL FISHERY

Rainbow trout.

	<u>Spring</u>	<u>Summer</u>	<u>Fall</u>	<u>Winter</u>	<u>Potential Recreation</u>	<u>S</u>	<u>S</u>	<u>F</u>	<u>W</u>
Heavy					Camping	X	X	X	
Medium					Fishing, boat	X	X	X	
Light					Fishing, shore	X	X	X	
					Hiking				
					Horseback riding				
					Hunting, big game				
					Hunting, upland game				
					Nature study				
					Picnicking	X	X	X	
					Sight-seeing				
					Swimming		X		
					Water skiing	X	X	X	

(Ct - Cutthroat trout, GT - Golden trout, LT - Lake trout, BT - Brook trout, Rb - Rainbow trout, Br - Brown trout, K - Kokanee, Ww - Warm water game fish)

REMARKS:

This is a potential reservoir proposed by the U. S. Soil Conservation Service.

LAKE AND RESERVOIR ACCESS EVALUATION

Priority _____

Name Pondosa Pond

County _____ Union _____

Location At Pondosa

Township 6 S Range 41 E Sec. 30 Ownership Private

DESCRIPTION

Terrain Large flat adjacent to the creek

Cover type Willows and grass

Elevation 3,375 Surface acres 3 Water quality Good

Existing access Paved state highway

ANGLER NEEDS

FISHERY

Planted rainbow trout.

				<u>Recreation</u>					
				S	S	F	W		
Heavy Medium Light	Spring	Summer	Fall	Winter					
	Rb	Rb	Rb		x	x	x		
(Ct - Cutthroat trout, GT - Golden trout, LT - Lake trout, BT - Brook trout, Rb - Rainbow trout, Br - Brown trout, K - Kokanee, Ww - Warm water game fish)					Camping				
					Fishing, boat				
					Fishing, shore	x	x	x	
					Hiking				
					Horseback riding				
					Hunting, big game				
					Hunting, upland game				
					Nature study				
					Picnicking				
					Sight-seeing				
					Swimming				
					Water skiing				

REMARKS:

This was an abandoned mill pond that has been rehabilitated for fishery management. A perpetual easement for angler use of the area has been obtained from the owners by the Oregon State Game Commission.

LAKE AND RESERVOIR ACCESS EVALUATION

Priority A

Name Roulet Pond

County Union

Location 4 miles northeast of Elgin.

Township 1 N Range 40 E Sec. 6 Ownership State Highway Dept.

DESCRIPTION

Terrain Flat farmland

Cover type Willows and grass

Elevation 3,200 Surface acres 1 - 2 Water quality Good

Existing access Paved state highway

ANGLER NEEDS

Sanitary facilities.

FISHERY

 Planted rainbow trout.

	Spring	Summer	Fall	Winter		<u>Recreation</u>			
	Rb	Rb				S	S	F	W
Heavy					Camping				
Medium					Fishing, boat				
Light			Rb		Fishing, shore	x	x	x	
					Hiking				
					Horseback riding				
					Hunting, big game				
					Hunting, upland game				
					Nature study				
					Picnicking				
					Sight-seeing				
					Swimming				
					Water skiing				

(Ct - Cutthroat trout, GT - Golden trout, LT - Lake trout, BT - Brook trout, Rb - Rainbow trout, Br - Brown trout, K - Kokanee, Ww - Warm water game fish)

REMARKS:

This pond receives heavy angling pressure in the spring and early summer before the high lakes thaw out in early summer.

LAKE AND RESERVOIR ACCESS EVALUATION

Priority A
Name Thief Valley Reservoir County Union

Location 15 miles east of North Powder
Township 6 S Range 40 E Sec. Many Tax Lot No. 2,100, 2,600
Ownership Public and private Number of owners 2

DESCRIPTION

Terrain Large flat along reservoir
Cover type Willow and grass
Existing access Gravel county road
Surface acres 723 Water quality Good Levels drawdown Irrigation
Present stage of development Irrigation reservoir with high water
ramp and sanitary facilities

ANGLER NEEDS

Acquisition: 200 acre minimum pool
Type of conveyance Purchase

* Development:

Boat ramp: Type Gravel Number of lanes 1
Toilets X Trails _____ Roads _____
Parking area X; for 100 cars or 50 car-trailer units

* This development needed only if a minimum pool can be acquired.

Thief Valley
Name Reservoir

FISHERY: Rainbow trout

Spring Summer Fall Winter

Heavy	Tr	Tr		
Medium			Tr	
Light				

(Sa - Salmon, Tr - Trout,
Ww - Warm Water Fishes)

SKETCH

Seasons (Check)

	Spring	Summer	Fall	Winter
X	X	X	X	
X	X	X	X	
X	X	X	X	
X	X	X	X	
X	X	X	X	
X	X	X	X	
X	X	X	X	

RECREATION
(Check)

- Boating, motor
- Boating, non-motor
- Camping, tent
- Camping, trailer
- Fishing, boat
- Fishing, shore
- Hiking
- Horseback riding
- Hunting, big game
- Hunting, upland game
- Hunting, waterfowl
- Nature study
- Picnicking
- Sightseeing
- Skin and scuba diving
- Swimming
- Water skiing

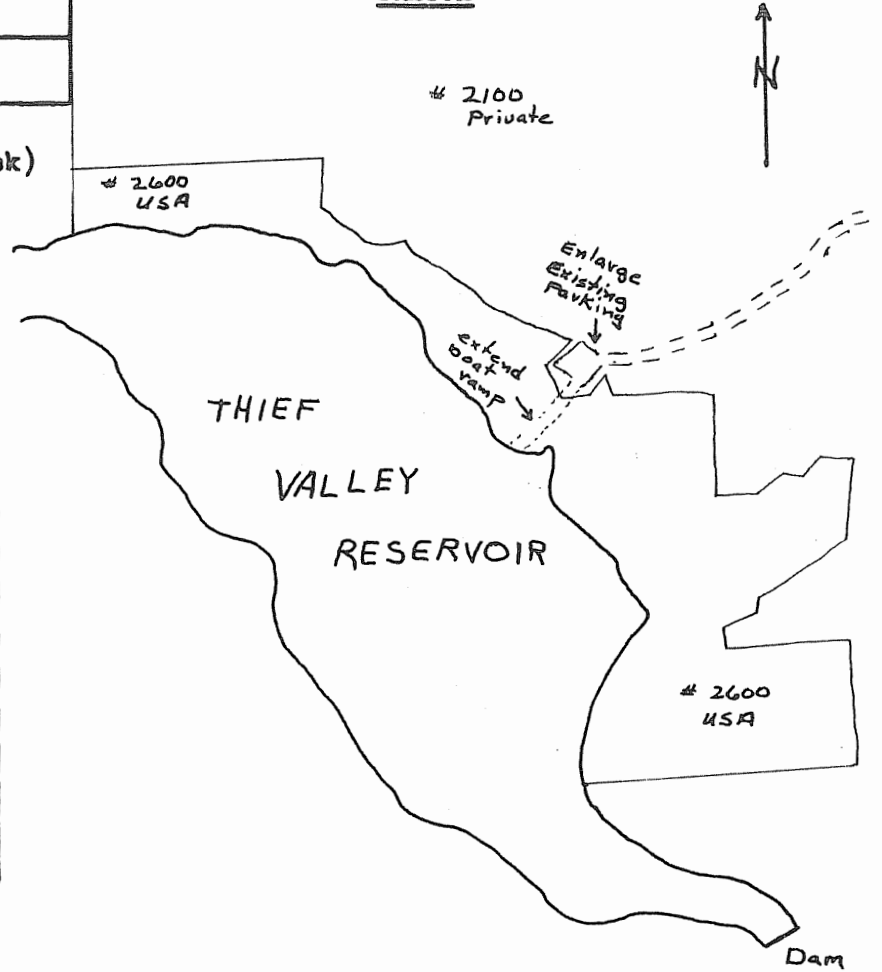

OTHER

Safety Problems:

Group Facilities:

REMARKS

LAKE AND RESERVOIR ACCESS EVALUATION

Priority A

Name Vogel Pond

County Union

Location 2 miles northwest of Union

Township 4 S Range 39 E Sec. 12 Ownership State Highway Dept.

DESCRIPTION

Terrain Flat farmland

Cover type Grass with a few willows along shoreline

Elevation 2,700 Surface acres 1 Water quality Good

Existing access Paved state highway

ANGLER NEEDS

Sanitary facilities.

FISHERY

 Rainbow trout and brown bullhead.

	Spring	Summer	Fall	Winter		<u>Recreation</u>			
	Rb, Ww	Rb, Ww				S	S	F	W
Heavy					Camping				
Medium					Fishing, boat				
Light			Rb, Ww		Fishing, shore	x	x	x	
					Hiking				
					Horseback riding				
					Hunting, big game				
					Hunting, upland game				
					Nature study				
					Picnicking				
					Sight-seeing				
					Swimming				
					Water skiing				

(Ct - Cutthroat trout, GT - Golden trout, LT - Lake trout, BT - Brook trout, Rb - Rainbow trout, Br - Brown trout, K - Kokanee, Ww - Warm water game fish)

REMARKS:

This pond receives heavy angling pressure in the spring when the higher lakes are still snowbound and the streams are high and murky from spring runoff.

LAKE AND RESERVOIR ACCESS EVALUATION

Priority C

Name Wolf Creek Reservoir

County Union

Location 6 miles west of North Powder

Township 6 S Range 38 E Sec. 11 Ownership Private

DESCRIPTION

Terrain Flat valley with moderate slopes

Cover type Willows, sagebrush and grass

Elevation Surface acres 233 Water quality Good

Existing access Gravel county road

ANGLER NEEDS

Minimum pool for fish management, campgrounds and boat facilities.

POTENTIAL FISHERY

 Rainbow trout.

	<u>Spring</u>	<u>Summer</u>	<u>Fall</u>	<u>Winter</u>	<u>Potential Recreation</u>	<u>S</u>	<u>S</u>	<u>F</u>	<u>W</u>
Heavy					Camping	X	X	X	
Medium					Fishing, boat	X	X	X	
Light					Fishing, shore	X	X	X	
					Hiking				
					Horseback riding				
					Hunting, big game				
					Hunting, upland game				
					Nature study				
					Picnicking	X	X	X	
					Sight-seeing				
					Swimming		X		
					Water skiing	X	X	X	

(Ct - Cutthroat trout, GT - Golden trout, LT - Lake trout, BT - Brook trout, Rb - Rainbow trout, Br - Brown trout, K - Kokanee, Ww - Warm water game fish)

REMARKS:

This is a potential reservoir proposed by the U.S. Soil Conservation Service.